

WASHROOM REQUIRED:
3.7.4.3. PLUMBING FIXTURES FOR ASSEMBLY OCCUPANCIES
(12) THE NUMBER OF WATER CLOSETS REQUIRED FOR DANCE HALLS AND RECREATIONAL ESTABLISHMENTS SHALL BE AT LEAST ONE FIXTURE FOR EACH 100 MALES AND ONE FIXTURE FOR EACH 75 FEMALES. OCCUPANT LOAD = 450 PERSONS = REQUIRED WASHROOM = 3 MALES + 3 FEMALES
(16) THE NUMBER OF WATER CLOSETS REQUIRED FOR PLACES OF WORSHIP AND UNDERTAKING PREMISES SHALL BE AT LEAST ONE FIXTURE FOR EACH 150 PERSONS OF EACH SEX. OCCUPANT LOAD = 450 PERSONS REQUIRED WASHROOM = 2 MALES + 2 FEMALES
NOTE:
THE TOTAL OCCUPANCY OF THE BUILDING IS 450 PERSONS.
WASHROOMS FACILITIES ARE PROVIDED ON THE GROUND FLOOR FOR 450 PERSONS AS PER 3.7.4.3 (16) 3 MEN + 3 WOMEN
AS PER ARTICLE 3.7.4.2., SENTENCE (7) THE WATERCLOSET AND LAVATORY PROVIDED IN THE UNIVERSAL WASHROOM MAYBE COUNTED AS PART OF THE PLUMBING FIXTURES REQUIRED FOR MALES AND FEMALES IF (a) MORE THAN ONE WATERCLOSET IS REQUIRED FOR MALES, AND (b) MORE THAN ONE WATERCLOSET IS REQUIRED FOR FEMALES.
BASEMENT WASHROOMS ARE FOR FUTURE (OVERFLOW), NOT REQUIRED AS PART OF THE TOTAL BUILDING OCCUPANCY.

WALL SCHEDULE:

P1	13 GYPSUM BOARD 92 METAL STUDS @ 400 o.c. 75 SOUND BATT INSULATION 13 GYPSUM BOARD TO U/S DECK	P2	13 GYPSUM BOARD 152 METAL STUDS @ 400 o.c. 150 SOUND BATT INSULATION 13 GYPSUM BOARD TO U/S DECK	P5	200 CONCRETE BLOCK w/ LADDER REINF. EVERY 2nd BLOCK COARSE.	P7	92 BRICK/STONE VENEER c/w MASONRY TIES 25 AIR SPACE 25 SPRAY FOAM INSULATION 13 DENSGLASS SHEATHING 152 METAL STUDS @ 400 o.c. 150 BATT INSULATION (R20) 6 mil POLY VAPOUR BARRIER 13 GYPSUM BOARD
P1a	13 GYPSUM BOARD 92 METAL STUDS @ 400 o.c. 15 GYPSUM BOARD TO 150 ABOVE CEILING	P3	16 GYPSUM BOARD TYPE 'X' 152 METAL STUDS @ 600 o.c. 150 SOUND BATT INSULATION 16 GYPSUM BOARD TYPE 'X' TO U/S DECK STC = 52 No fire rating required	P6	ELEVATOR SHAFT WALLS: 240 CONCRETE BLOCK CORES FILLED SOLID w/ LADDER REINF. EVERY 2nd BLOCK COARSE.	P8	WATERPROOFING 300 CONCRETE FOUNDATION WALL 25 AIR SPACE 92 METAL STUDS @ 600 o.c. 75 SPRAY FOAM INSULATION (R19) 13 GYPSUM BOARD
P1b	16 GYPSUM BOARD TYPE 'X' 92 METAL STUDS @ 400 o.c. 75 SOUND BATT INSULATION 16 GYPSUM BOARD TYPE 'X' TO U/S DECK 1 HR. FRR (OBC-SB3 S5b) STC = 52	P4	13 GYPSUM BOARD 203 METAL STUDS @ 400 o.c. 150 SOUND BATT INSULATION 13 GYPSUM BOARD TO U/S DECK	P6a	101 STUCCO COATING RIGID INSULATION w/DRAINAGE SYSTEM AIR BARRIER AS PER EPIS MANUF. 13 DENSGLASS SHEATHING 152 METAL STUDS @ 400 o.c. 150 BATT INSULATION (R20) 6 mil POLY VAPOUR BARRIER 13 GYPSUM BOARD	P9	300 CONCRETE FOUNDATION WALL
P1c	13 GYPSUM BOARD 92 METAL STUDS @ 400 o.c. 75 SOUND BATT INSULATION TO U/S DECK					P10	13 GYPSUM BOARD 300 CONCRETE FOUNDATION WALL 13 GYPSUM BOARD

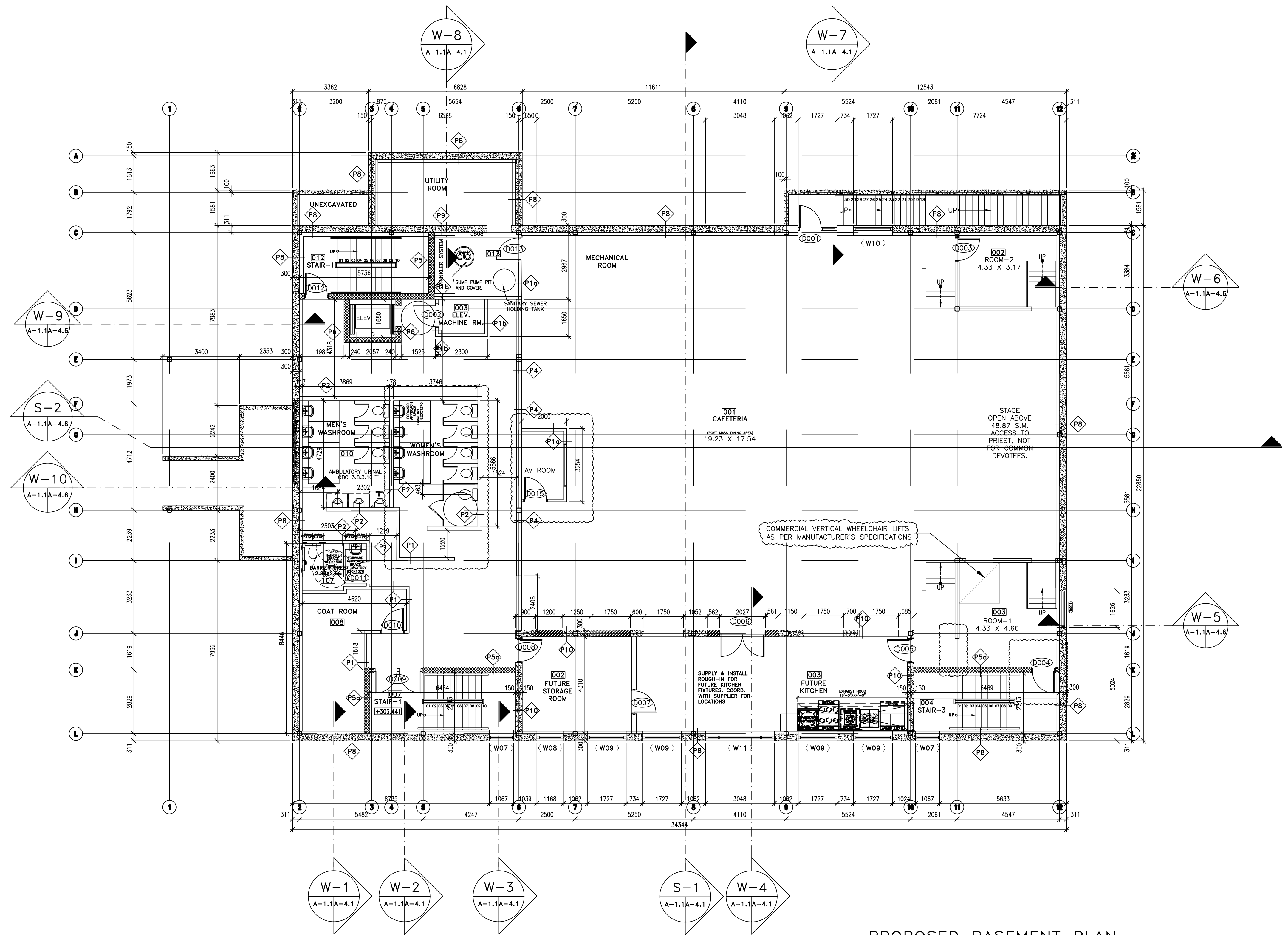

NO.	ISSUED FOR	DATE
14.	MECHANICAL ROOM DOOR MOVE	SEP 6/2024
13.	EXTERIOR ELEVATION UPDATE	AUG 27/2024
12.	IFC REVISION 1	MAR 14/2024
11.	BBE REVISIONS	NOV. 9/2023
10.	REVISED AS RSM COMMENTS	JULY 11/2022
09.	PERMIT	APR. 09/2022
08.	REVISED AS CITY'S COMMENT - SP APPLICATION	JULY 20/2021
07.	REVISED AS CITY'S COMMENT - SP APPLICATION	APR. 12/2021
06.	SITE PLAN APPLICATION	NOV. 30/2020
05.	PROGRESS DRAWINGS-REVISED AS TEMPLE DIRECTOR COMMENT	NOV. 11/2020
04.	REVISED AS TEMPLE DIRECTOR COMMENT - WEST ENTRY	OCT. 22/2020
03.	PROGRESS DRAWINGS - REVISED REVIEW	OCT. 20/2020
02.	OWNER'S REVISED REVIEW	OCT. 19/2020
01.	RAM'S REVIEW	OCT. 17/2020

PROJECT NAME AND LOCATION
PROPOSED RADHA KRISHNA MANDIR AND CULTURAL CENTRE INC.
85 BOXWOOD DRIVE
CAMBRIDGE, ONTARIO - N3E 0E5

DRAWING TITLE
PROPOSED BASEMENT PLAN

NOTE:
- DO NOT SCALE DRAWINGS.
- ALL DIMENSIONS TO BE CHECKED AND VERIFIED ON THE JOB SITE.
- ANY AND ALL DISCREPANCIES TO BE REPORTED TO THE ARCHITECT.
- ALL DRAWINGS REMAIN THE PROPERTY OF THE ARCHITECT.

PROJECT NO.	2055	A BC
DATE	OCT. 2020	
DRAWN BY	V.P./K.V.	
CHECKED BY	CJV	
DRAWING NO.		A. DETAIL NO. B. LOCATION C. DETAILED SHEET

PROPOSED BASEMENT PLAN
SCALE: 1:100
NOTE: THIS DRAWING IS BASED ON DRAWING AS PROVIDED BY THE OWNER.

A-1.1