

9898 HOLLY CRESCENT,  
WINDSOR, ONTARIO,  
CANADA N8R 1Z3  
PHONE: (519) 979-9017  
CELL: (519) 567-1800  
FAX: (519) 979-4909  
EMAIL: chintan@chintan.ca  
WWW.CHINTAN.CA

**WASHROOM REQUIRED:**  
3.7.4.3. PLUMBING FIXTURES FOR ASSEMBLY OCCUPANCIES

(12) THE NUMBER OF WATER CLOSETS REQUIRED FOR DANCE HALLS AND RECREATIONAL ESTABLISHMENTS SHALL BE  
AT LEAST ONE FIXTURE FOR EACH 100 MALES AND ONE FIXTURE FOR EACH 75 FEMALES.  
OCCUPANT LOAD = 450 PERSONS - REQUIRED WASHROOM = 3 MALES + 3 FEMALES

(16) THE NUMBER OF WATER CLOSETS REQUIRED FOR PLACES OF WORSHIP AND UNDERTAKING PREMISES SHALL BE  
AT LEAST ONE FIXTURE FOR EACH 150 PERSONS OF EACH SEX.  
OCCUPANT LOAD = 450 PERSONS REQUIRED WASHROOM = 2 MALES + 2 FEMALES

NOTE:  
THE TOTAL OCCUPANCY OF THE BUILDING IS 450 PERSONS.  
WASHROOMS FACILITIES ARE PROVIDED ON THE GROUND FLOOR FOR 450 PERSONS AS PER 3.7.4.3.  
(16) 3 MEN + 3 WOMEN

AS PER ARTICLE 3.7.4.2., SENTENCE (7) THE WATERCLOSET AND LAVATORY PROVIDED IN THE UNIVERSAL WASHROOM MAYBE COUNTED AS PART OF THE PLUMBING FIXTURES REQUIRED FOR MALES AND FEMALES IF (a) MORE THAN ONE WATERCLOSET IS REQUIRED FOR MALES, AND (b) MORE THAN ONE WATERCLOSET IS REQUIRED FOR FEMALES.

BASEMENT WASHROOMS ARE FOR FUTURE (OVERFLOW), NOT REQUIRED AS PART OF THE TOTAL BUILDING OCCUPANCY.

**WALL SCHEDULE:**

- P1 13 GYPSUM BOARD  
92 METAL STUDS @ 400 o.c.  
75 SOUND BATT INSULATION  
13 GYPSUM BOARD  
TO U/S DECK
- P2 13 GYPSUM BOARD  
152 METAL STUDS @ 400 o.c.  
13 GYPSUM BOARD  
TO U/S DECK
- P3 16 GYPSUM BOARD TYPE 'X'  
152 METAL STUDS @ 600 o.c.  
150 SOUND BATT INSULATION  
16 GYPSUM BOARD TYPE 'X'  
TO U/S DECK  
STC = 52  
No fire rating required
- P4 13 GYPSUM BOARD  
203 METAL STUDS @ 400 o.c.  
150 SOUND BATT INSULATION  
13 GYPSUM BOARD  
TO U/S DECK
- P5 200 CONCRETE BLOCK  
w/ LADDER REINF. EVERY 2nd  
BLOCK COARSE.
- P6 ELEVATOR SHAFT WALLS:  
240 CONCRETE BLOCK  
CORES FILLED SOLID  
w/ LADDER REINF. EVERY 2nd  
BLOCK COARSE.
- P7 92 BRICK/STONE VENEER c/w  
MASONRY TIES  
25 AIR SPACE  
25 SPRAY FOAM INSULATION (R19)  
13 DENSGLASS SHEATHING  
152 METAL STUDS @ 400 o.c.  
150 BATT INSULATION (R20)  
6 mil POLY VAPOUR BARRIER  
13 GYPSUM BOARD
- P8 WATERPROOFING  
300 CONCRETE FOUNDATION WALL  
25 AIR SPACE  
92 METAL STUDS @ 600 o.c.  
75 SPRAY FOAM INSULATION (R19)  
13 GYPSUM BOARD
- P9 300 CONCRETE FOUNDATION WALL
- P10 13 GYPSUM BOARD  
92 METAL STUDS @ 400 o.c.  
75 SOUND BATT INSULATION  
13 GYPSUM BOARD  
TO U/S DECK
- P11 16 GYPSUM BOARD TYPE 'X'  
92 METAL STUDS @ 400 o.c.  
75 SOUND BATT INSULATION  
16 GYPSUM BOARD TYPE 'X'  
TO U/S DECK  
1 HR. FRR (OBC-SB3 S5b)  
STC = 52
- P12 13 GYPSUM BOARD  
92 METAL STUDS @ 400 o.c.  
75 SOUND BATT INSULATION  
TO U/S DECK
- P13 101 STUCCO COATING RIGID  
INSULATION w/ DRAINAGE SYSTEM  
AIR BARRIER AS PER EFIS MANUF.  
13 DENSGLASS SHEATHING  
152 METAL STUDS @ 400 o.c.  
150 BATT INSULATION (R20)  
6 mil POLY VAPOUR BARRIER  
13 GYPSUM BOARD

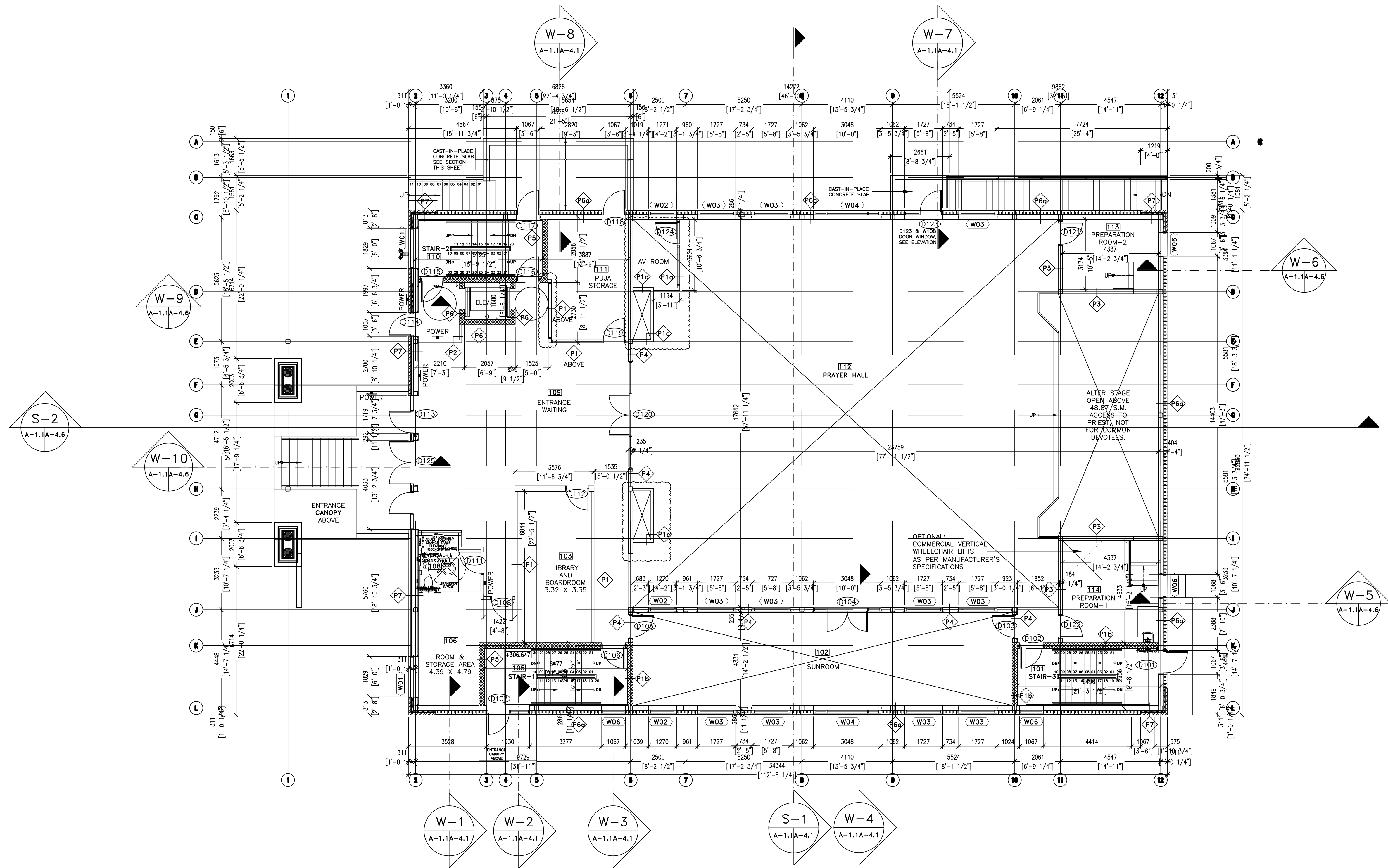

NO.	ISSUED FOR	DATE
14.	ENTRY AND WASHROOM CHANGE	SEP. 6/2024
14.	EXTERIOR ELEVATION UPDATE	AUG. 27/2024
14.	IFC REVISION 1	MAR. 14/2024
13.	BBE REVISIONS	NOV. 09/2023
12.	REVISED STAIRCASE-3 DOOR	APR. 03/2023
11.	REVISED - CANOPY RELOCATED IN BUILDING CENTRE	SEPT. 29/2022
10.	REVISED AS RSM COMMENTS	JULY 11/2022
09.	PERMIT	APR. 09/2022
08.	REVISED AS CITY'S COMMENT - SP APPLICATION	JULY 20/2021
07.	REVISED AS CITY'S COMMENT - SP APPLICATION	APR. 12/2021
06.	SITE PLAN APPLICATION	NOV. 30/2020
05.	PROGRESS DRAWINGS-REVISED AS TEMPLE DIRECTOR COMMENT	NOV. 11/2020
04.	REVISED AS TEMPLE DIRECTOR COMMENT - WEST ENTRY	OCT. 22/2020
03.	PROGRESS DRAWINGS - REVISED REVIEW	OCT. 20/2020
02.	OWNER'S REVISED REVIEW	OCT. 19/2020
01.	RAM'S REVIEW	OCT. 17/2020

**PROJECT NAME AND LOCATION**

**PROPOSED RADHA KRISHNA MANDIR AND CULTURAL CENTRE INC.**

85 BOXWOOD DRIVE  
CAMBRIDGE, ONTARIO - N3E 0E5

**DRAWING TITLE**

**PROPOSED FIRST FLOOR PLAN**

**NOTE:**  
- DO NOT SCALE DRAWINGS.  
- ALL DIMENSIONS TO BE CHECKED AND VERIFIED ON THE JOB SITE.  
- ANY AND ALL DISCREPANCIES TO BE REPORTED TO THE ARCHITECT.  
- ALL DRAWINGS REMAIN THE PROPERTY OF THE ARCHITECT.

PROJECT NO.	2055	A BC
DATE	OCT. 2020	
DRAWN BY	V.P./K.V.	A. DETAIL NO. B. LOCATION C. DETAILED SHEET
CHECKED BY	CJV	
DRAWING NO.		